

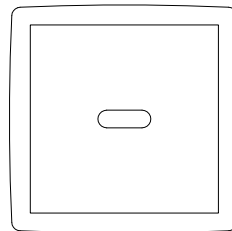

INSTALLATION INSTRUCTIONS

ELITE WALL MOUNTED SENSOR TAP

ET2-20.5

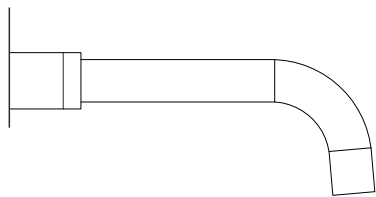

Thank you for purchasing this Enviro-Tech product



INSTALLATION INSTRUCTIONS ELITE WALL MOUNTED SENSOR TAP

We strongly recommend that you use a qualified and registered plumber and electrician. You must ensure that all pipe work is flushed adequately, particularly in new builds or where lines have been disrupted. Components of sensor taps are particularly susceptible to debris and will require more thorough flushing than a standard plumbing fixture. Failure to flush lines adequately will result in blocked or leaking valves (check/solenoid) or a dripping tap soon after installation and is not covered by the Enviro-Tech warranty.

TECHNICAL SPECIFICATION

Function	ET2-20.5
Power Input	DC:6V(4x1,5V AA alkaline battery) AC:220-240V (50/60 Hz)
Power consumption	Static:<4Ma,active:<500mA
Water Pressure	100kPa-500kPa
Inlet/outlet Diameter	15mm ½ G
Detection zone	300-600mm (Adjustable - see Sensor Adjustment)
Confirmation time	1 second
Low power consumption	4 AA alkaline batteries 108,000 cycles

COMPONENTS

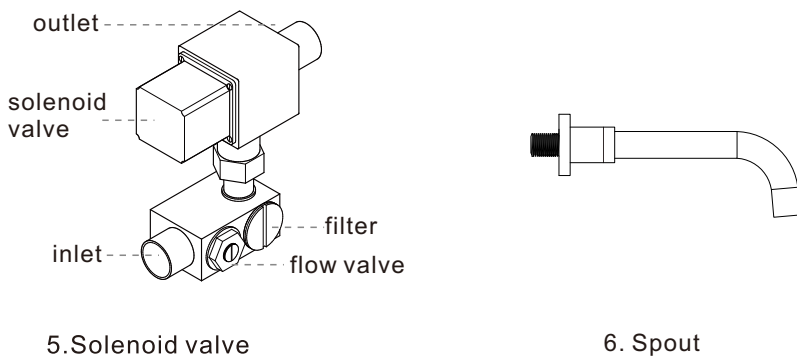
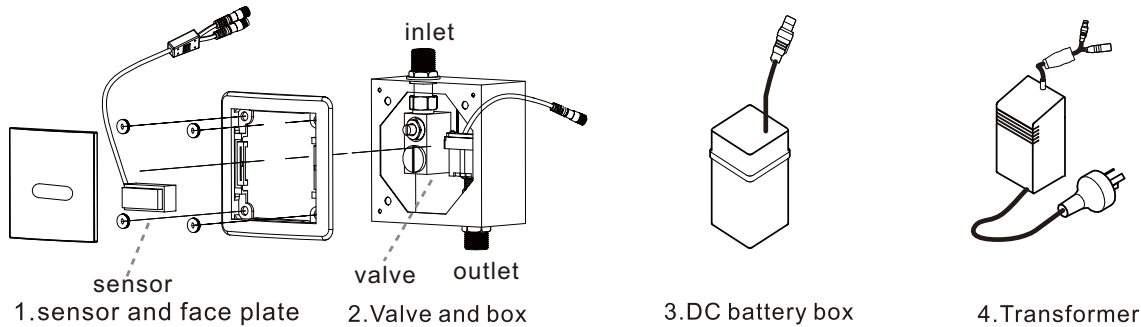

VALVE BOX INSTALLATION

1. Fix control box within wall, can be side or rear fixed.

2. Attach face plate to control box.

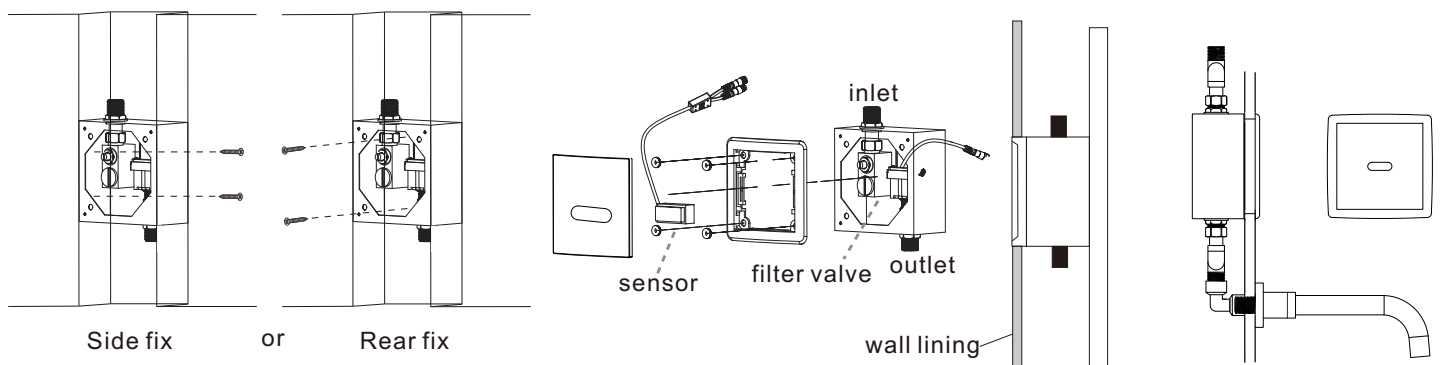

INSTALLATION STEPS

- >Fix valve box within wall- only faceplate will be visible after install complete. Plastic packing cover screws on to box to protect internals after rough-in stage. Faceplate to be fixed on finishing.
- >Fix spout to wall
- >Connect water feed to inlet valve
- >Connect outlet to spout
- >Insert batteries to DC battery box
- >Connect battery box to transformer.(If mains powered)
- >Connect transformer (battery box if DC only) to face plate
- >Connect solenoid valve to face plate plug
- >Connect transformer to power
- >Turn on water and test

CABLE CONNECTION

WARNING: If parts are connected incorrectly electronics can be damaged!

1. Insert batteries to DC battery box and connect battery box to transformer. (If mains powered)

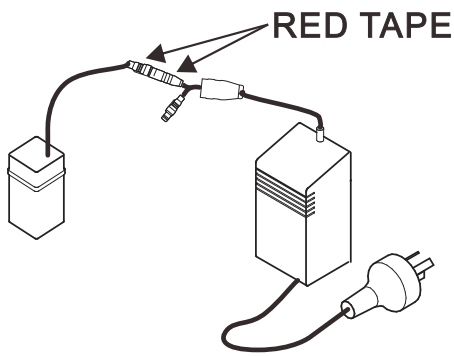

2. Connect transformer (battery box if DC only) to faceplate.

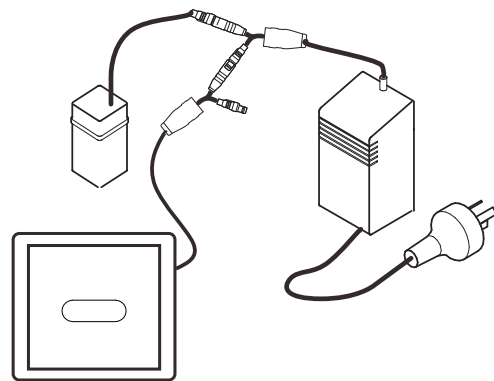

3. Connect solenoid valve to faceplate plug.

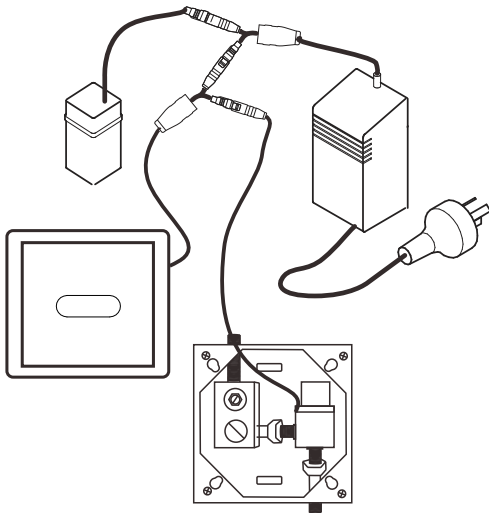

4. Connect transformer to power.

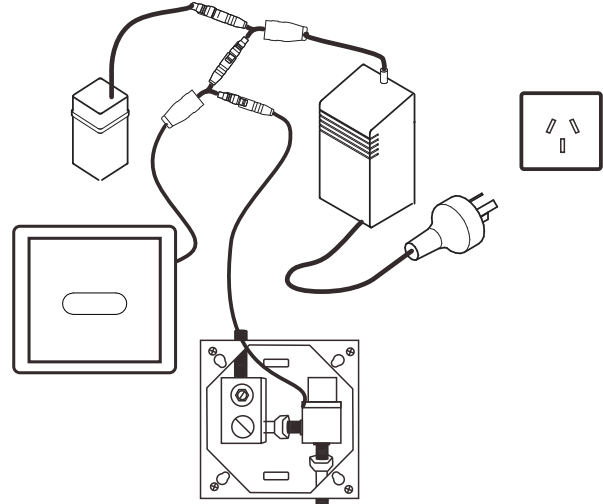

SENSOR ADJUSTMENT

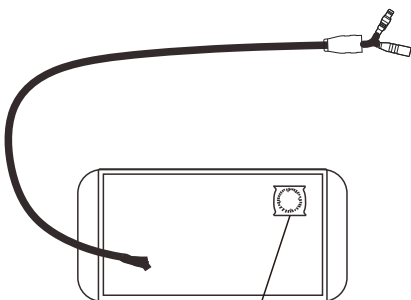

Distance adjustment

Clockwise to Min. distance
Anticlockwise to Max. distance
Small gentle 1/4 turn only - screw will break if treated roughly.

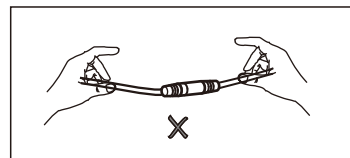
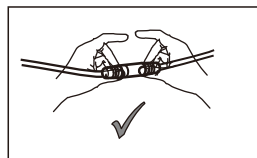

Attention:

Hold the plug not the wire to connect and disconnect and make sure the pins align to the holes in the right position.

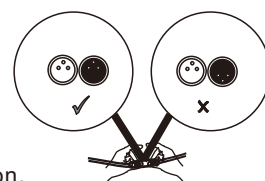

TROUBLE SHOOTING

Problem	Possible Cause	Solution
No water out or water will not turn off	Most common: No water supply/No Power Sensor obstructed	<ul style="list-style-type: none">• Check water and power supply, change batteries.• Unplug all cables, leave unplugged for 5 minutes and reconnect everything carefully.• If Mains - reconnect battery box to transformer before the sensor cable. Clean sensor
Too little water flow	Low water pressure/pressure is turned down The filter or solenoid is dirty	Adjust/raise the pressure Clean the filter. Clean/replace solenoid
Too much water flow	Water pressure is too high	Adjust pressure
Indicator light is off/flashing	Batteries are flat Bad connection	Replace batteries Check connections
Run time not adequate	Sensor requires adjustment	See Sensor Adjustment Diagram. Care is required, small gentle ¼ turn only and retest advised. Adjustment screw can break if mistreated and may not be covered by your product warranty.
Tap is self-activating	All infra-red technology can be affected by strong or directional light, reflective surfaces or high-viz clothing. This is due to environmental factors and is not a product fault.	

For detailed troubleshooting advice, see the Installation page of our websites enviro-tech.com.au or enviro-tech.co.nz or call us on the numbers below.



WARRANTY

Enviro-Tech warrants that all tap bodies and standard chrome finish be guaranteed for 5 years from the date of purchase. All non-standard finishes are guaranteed for 2 years from the date of purchase with a 12 month repair or replacement warranty on all other products and parts. For full details of the warranty conditions, see the Warranty page of our websites.

AFTERCARE

Ensure good water quality is maintained and the filter on the solenoid valve is cleaned out regularly. Failure to do so could result in a blocked solenoid/dripping tap and may invalidate your warranty. Whilst advanced plating techniques are used in the manufacture of this product. The surface will be affected if cleaned incorrectly. Surfaces should be maintained using a clean damp cloth, no abrasive agents or materials should be used or come into contact with the surface finish, or this will invalidate your warranty.

This Enviro-Tech product is manufactured strictly to adhere to the ISO9001 standard, WaterMark certification and WELS standards. Enviro-tech reserves the right to update product technology at any time.

Contact Info:

Australia – 1300 530 883 or info@enviro-tech.com.au

New Zealand – 0800 2 ENVIRO or info@enviro-tech.co.nz